

INCLUDED PARTS:

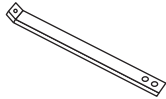

Screws



Support bars

SUGGESTED TOOLS & MATERIALS:

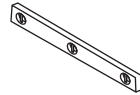

Level

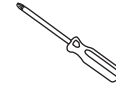

Screwdriver



Drop Cloth

INSTALLATION INSTRUCTIONS:

1. Flip tub upside-down using a drop cloth to help prevent damages.

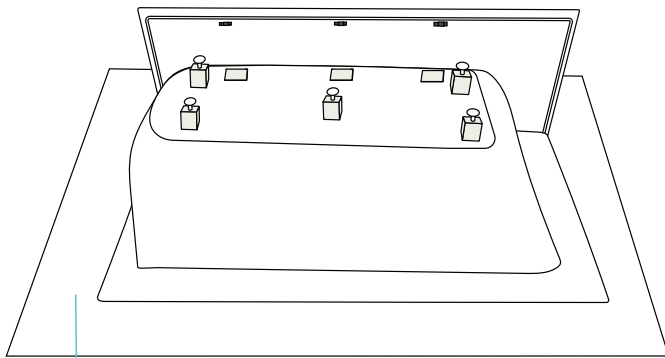

Drop Cloth

2. Insert one support bar into the hook on the back of the tub apron.

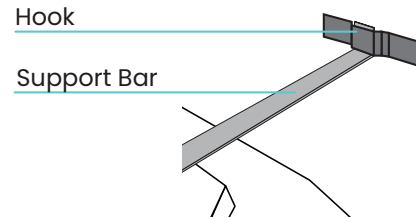

3. Use a level to verify the tub apron is vertical to the ground.

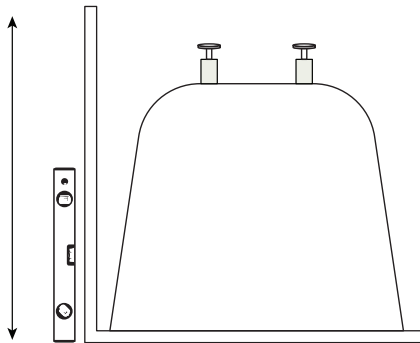

4. Screw the flat end of the support bar into the raised wood platform on the bottom of the tub.

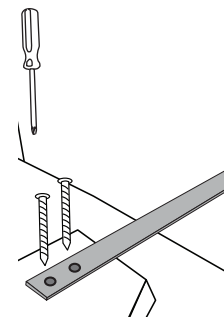

5. Use a level to verify the tub apron is horizontally level. Repeat steps 2-4 for the remaining two support bars.

